

CORDLESS MINI CHAINSAW



INSTRUCTION MANUAL

Thanks for choosing Kwik Shear!

Dear users, first of all, thank you for choosing our high quality products!

In order to maximise use of this product, please read the instructions carefully before use. Keep this manual for future reference.

If you have any issues or questions regarding use, please get in touch with us at enquiries@newstyledirect.com.au or enquiries@newstyledirect.co.nz.

Our customer service assistants are available to answer your questions. Happy pruning!

Packing list

The Kwik Shear Cordless Mini Chainsaw kit contains the following:

- | | | |
|-----------------|------------|-----------------------|
| 1. Kwik Shear | 3. Charger | 5. Lubricating oil |
| 2. Battery pack | 4. Tools | 6. Instruction manual |



Setting up the Kwik Shear Cordless Mini Chainsaw

1. Install the guide plate to the host, the guide plate screw hole is flush with the first screw

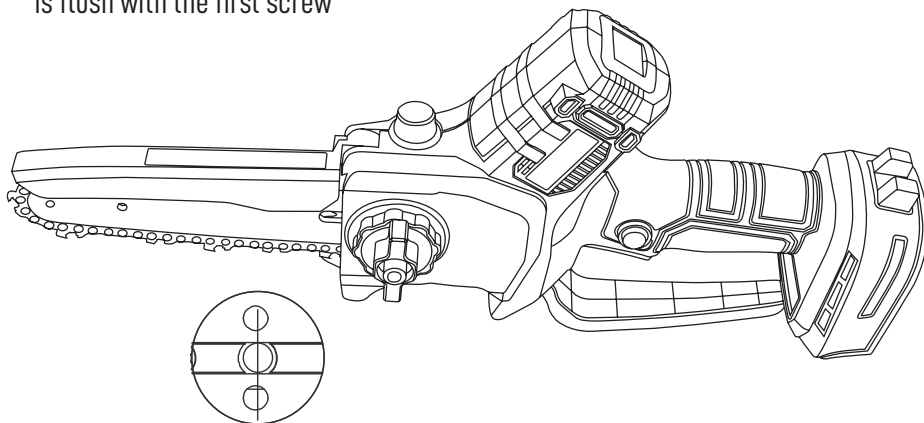

2. Install the chain

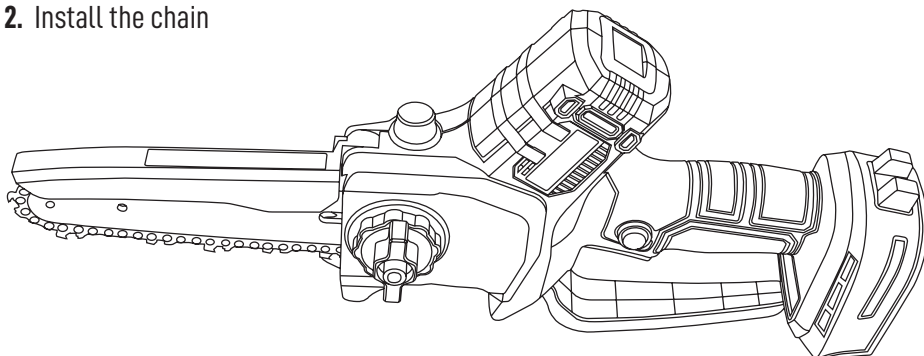

Removing the chain

To remove chain, loosen compression button, remove the side cover and after removing the side cover (as shown in the illustration), remove the guide directly.

Installing the chain guide plate

To install the chain guide plate, first load the chain into the guide plate, and insert the middle guide tooth into the guide plate guide slot.

Note:

- The chain blade should be forward.
- The charging chainsaw has a device to adjust the tensioning of the chain.
- When installing the guide plate, please ensure that the adjusting block is inserted into the positioning adjusting hole at the end of the guide plate.

- 3.** Place Guide Bar's lower hole over Tension Pin. Check again that the Saw Chain cutters are aligned properly and the Saw Chain drive links are seated completely in the slot of the Guide Bar. Tighten Tensioning Screw until bottoms of cutters contact bottom of Guide Bar.

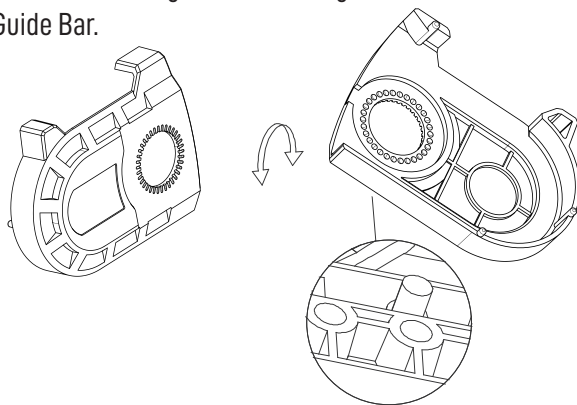

- 4.** Align the convex points of the adjusting screws on the guide plate cover with the guide plate holes to install the guide plate cover

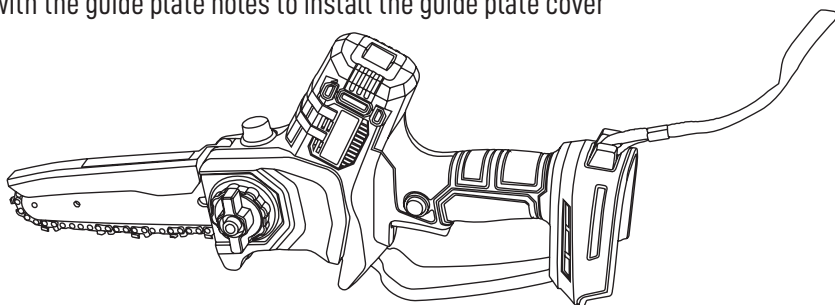

- 5.** Turn the knob on the guide plate cover clockwise, pull the chain down when you turn the knob. Take care, as this can rebound quickly when you loosen the chain.

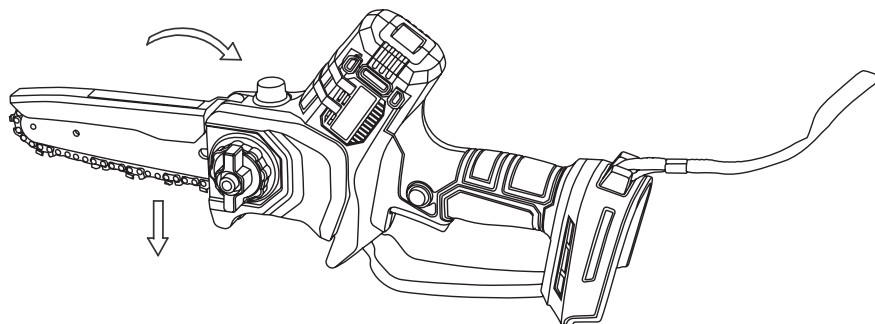

6. Use a socket wrench to tighten the outer hexagonal nut, and then screw the 3x14 screw into the hole of the guide plate cover

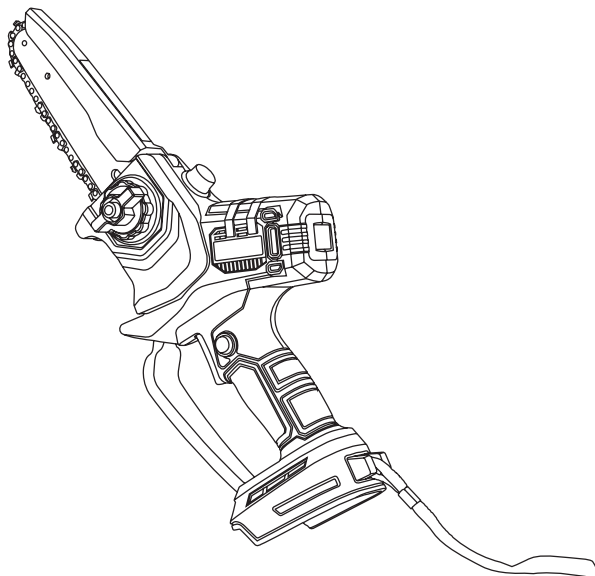

7. Unscrew the oiler lid, pour the lubricating oil into the oiler, and tighten the oiler lid (the product does not provide lubricating oil)

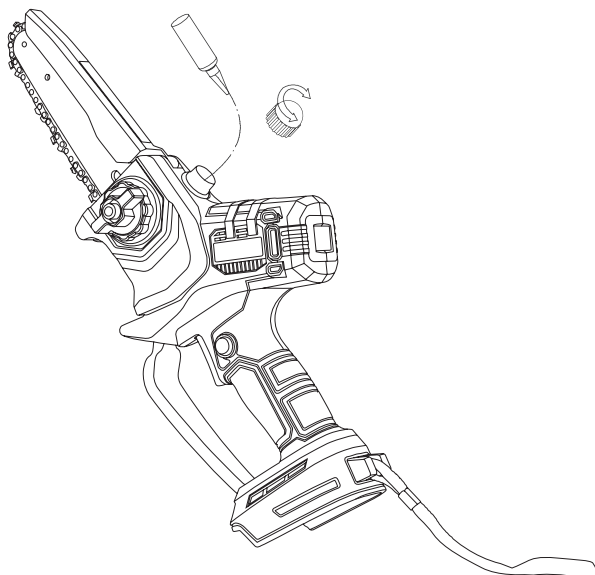

8. Pack the battery into the machine

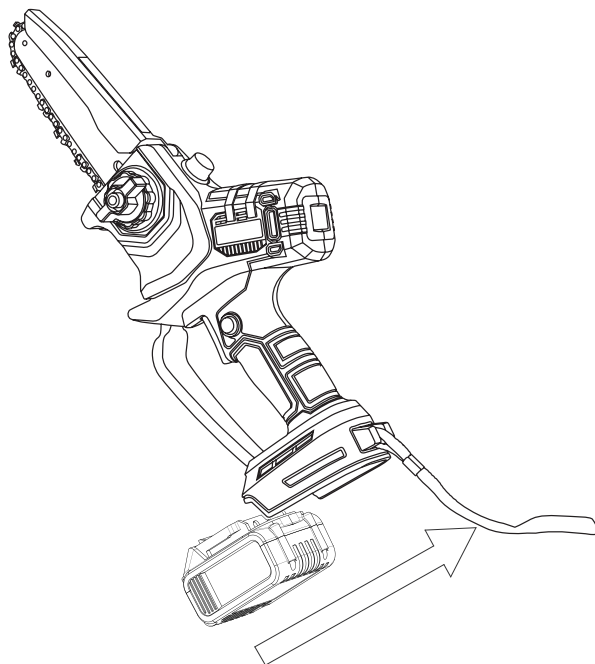

9. Press the switch to start the machine

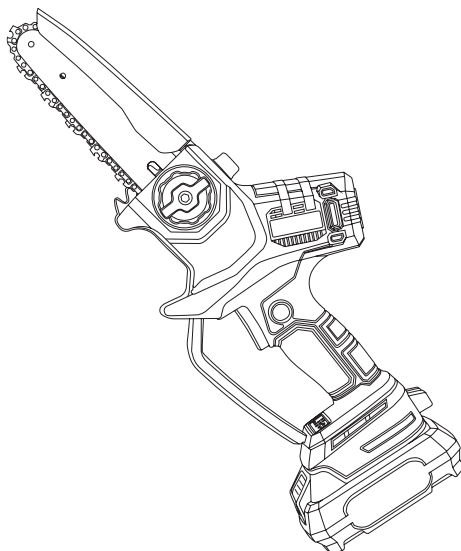

Use and maintenance

Charging the battery

1. Do not expose the battery to extreme conditions such as high temperature or shock, doing this may cause personal injury due to the leakage of the electrolytic solution.
2. Before charging, check that the surface of the battery is clean and dry.
3. Before delivery, the battery of this product is not fully charged. Therefore, before the first use, please charge it..
4. Do not charge the battery for long periods of time, and do not run out of all the power in the soap tank, otherwise it will damage the battery
5. The warranty does not include failure due to incorrect use
6. When the battery life becomes becomes significantly shorter, it should be replaced.
7. The user should only use the battery pack from the original manufacturer.

Always keep in mind applicable safety instructions and protection requirements and environmental information

1. Put the charger in the room between +10°C and +22°C, and avoid moisture entering
2. Check that the switch is in **OFF** position.
3. Connect the charger to the corresponding connector for the battery pack
4. Make sure the power is consistent with the rated values on the charger and adapter
5. When the red light is on, it indicates that the battery is charging, and the green light indicates that the charge is completed. The average charge time is 2 hours.
6. When charging is complete, disconnect from the power source and remove the connector from the battery.
7. Ensure that the battery is recharged at least once every three months

Conditions of work

1. Maintain charging temperature 0C-45C for charger and battery pack, discharge temperature -10C – 60 C for battery pack.

Operating instructions

Please wear suitable clothing and work gloves when using this tool. Before each use, make sure the chain is running normally, start/off switch and safety switch must be ready for normal use. When loosening the start switch, the power must be turned off. If the switch is damaged, stop using the device. Make sure the voltage of the power supply is consistent with the voltage on the nameplate. The risk of injury can be reduced by wearing protective devices and ensuring that the devices are functioning properly.

Confirm the frequency of the operation to ensure that the operation is in the best condition.

In order to save the battery and ensure the best service life of the electric chain saw, don't let the machine overload and do not cut dry or wet branches with a diameter of more than 130mm.

When cutting the knife edge mode to stop the operation, turn off the power switch and remove the battery from the unit.

Safety Precautions

When the device is running, keep your other hand is at least 15cm away from the cutting area of the blade, and keep the chain edge away from any body parts.

Do not use this equipment to force the bigger branches, otherwise it may make the blade deform and make the chain stick.

In cold or humid weather, to protect the battery pack, put it under waterproof clothing, do not use this equipment in rainy days

We recommend that after daily use, the connection between the mini chainsaw and the battery pack be separated, and the power switched off and put together into the tool box provided.

If the user feels the power is not enough or the cutting is not smooth enough, check if the battery is flat or the blade is dull.

Cleaning and maintenance

1. Repair functions not mentioned herein should be performed by the authorised service centre. To ensure the safety of use, only the original parts should be used.
2. Repair work functions not mentioned in this specification should be performed only by the authorised service centre. To ensure safe use, only original parts should be used. When you are finished using the chainsaw, turn off the power switch and disconnect the battery.

KWIK SHEAR WARRANTY

The KWIK SHEAR tool, battery and charger are covered by a 2 year warranty.

This warranty does not include wear and tear on consumable parts. Proof of purchase is required.

WARRANTY PROCESS

Kwik Shear Australia and Kwik Shear New Zealand warrants each new Kwik Shear to the original purchaser thereof, to be used and maintained properly. This shall be in lieu of any other warranty, expressed or implied, including, but not limited to, any implied warranty of merchantability or fitness for a particular purpose.

Kwik Shear Australia and Kwik Shear New Zealand shall repair or replace, at its option and without cost to the original purchaser, any Kwik Shear or warranted part that has been found to be defective and is within the period of the warranty. All freight to and from Kwik Shear Australia or Kwik Shear New Zealand is to be paid for by the customer.

The liability of Kwik Shear Australia and Kwik Shear New Zealand under this warranty shall be limited solely to repair or replacement of the Kwik Shear body and warranted parts within the warranty period; and Kwik Shear New Zealand shall not be liable, under any circumstances, for consequential or incidental damages, including, but not limited to, personal injury or labor costs. This warranty gives the original purchaser specific legal rights and you may also have other rights which vary from state to state.

Under no circumstances will Kwik Shear Australia and Kwik Shear New Zealand be responsible for any expense in connection with any repairs made by anyone other than the Kwik Shear Australia and Kwik Shear New Zealand or authorised repairers, unless repairs have been specifically authorised in writing by Kwik Shear Australia or Kwik Shear New Zealand.

If you have any questions about your warranty registration, you can contact us at:

Kwik Shear Australia • Email: enquiries@newstyledirect.com.au • Ph: +61 3 9489 1177

Kwik Shear New Zealand • Email: enquiries@newstyledirect.co.nz • Ph: +64 09 478 2717



www.kwikshear.com.au

www.kwikshear.co.nz

